

PA-Series, Air Hydraulic Foot Pumps

ENERPAC 

▼ Shown: PA1150, PA133



PA Series

Reservoir Capacity:
0,6 - 1,3 litres

Flow at Rated Pressure:
0,13 l/min

Air Consumption:
255 l/min

Maximum Operating Pressure:
700 bar



Reservoir Conversion Kit

Double the reservoir capacity of your existing PA133 with this easy to install conversion kit.

Model Number

PC66

- Rugged construction – built for long life and easy service
- Swivel coupling simplifies hydraulic connection and pump operation
- Three-position treadle provides cylinder advance, hold or retract operation
- Operates in all positions for increased versatility in use and mounting (except PA1150)
- Base mounting slots provided on PA133.

OIL FLOW VERSUS PRESSURE

at 6,9 bar air pressure

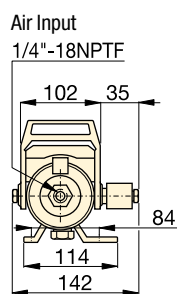
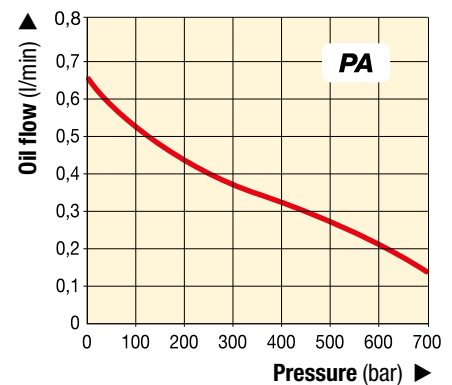

PA133

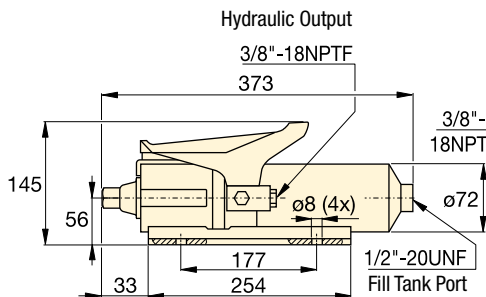

PA1150

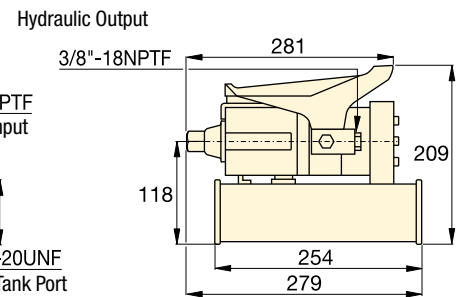
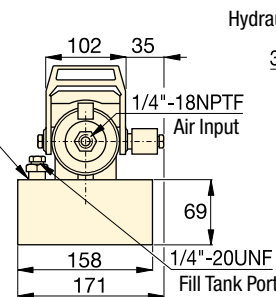

| Used with Cylinder | Usable Oil Capacity (cm ³) | Model Number | Pressure Rating (bar) | Output Flow Rate (l/min) | | Valve Function | Air Pressure Range * (bar) | Air Consumption (l/min) | Sound Level (dBA) |  (kg) |
|--------------------|--|--------------|-----------------------|--------------------------|------|--------------------------|----------------------------|-------------------------|-------------------|--|
| | | | | No load | Load | | | | | |
| Single-Acting | 589 | PA133 | 700 | 0,65 | 0,13 | Advance / Hold / Retract | 4,1 - 8,3 | 255 | 85 | 5,4 |
| | 1311 | PA1150 | 700 | 0,65 | 0,13 | Advance / Hold / Retract | 4,1 - 8,3 | 255 | 85 | 8,2 |